



# Post Modern Architecture Application on One Tree Hill Hotel Resort

*Firman Eddy*<sup>1\*</sup>, *Mhd.Bismar Harahap*<sup>1</sup>

<sup>1</sup>Architecture Department, Faculty of Engineering , Universitas Sumatera Utara, Medan, Indonesia

**Abstrak.** Resort hotels are hotels built on tourist attractions, mountains, beaches, and lakes. In this design, there is a problem, namely the Contour site, located at an altitude of 1675 masl; there is a very diverse local wisdom. The purpose of this hotel development course is as an accommodation facility from tourist activity, developing the Simalem Park area, preserving the local wisdom of North Sumatra. This resort hotel not only provides accommodation facilities, but it also has elements of local wisdom from seven tribes in North Sumatra. Of the seven tribes in North Sumatra, ethnic characteristics are designed as facades or ornaments, as a way to support sustainability and appreciate the local wisdom in North Sumatra. The theme is Respect To The Traditions which functions to revitalize local wisdom with a more visible appearance. Modern but do not forget the rules that existed in the past, as a design methodology. The results of this design were built in One Tree Hill resort hotel. This design was made as an analysis, concept, and solution for Simalem Park managers who planned to build a resort hotel in One Tree Hill.

**Keywords:** hotel resort, north Sumatra local wisdom, post-modern architecture

## 1. Introduction

In the current millennial era, the human need for recreation and leisure is a very high necessity due to arousal, stress due to daily routines makes humans need a quiet place to rest and relax for a while from their routine. Of these needs make tourism objects as a destination for vacation and recreation. Tourism objects in North Sumatra need to be developed because there are no facilities or accommodation for tourists. There are seven tribes in North Sumatra, namely Karo Batak, Simalungun Batak, Pakpak Batak. Toba Batak, Batak Mandailing, Batak Angkola, Nias, Melayu [1]. But in this millennial era, culture is increasingly forgotten because of the increasingly modern times regarding culture and buildings. Therefore, it is needed a medium for recreation that is modern but has a cultural element.

---

\*Corresponding author at: Architecture Department, Faculty of Engineering, Universitas Sumatera Utara, Perpustakaan Street, Build J07, Medan 20155

E-mail address: rechvidimaz@yahoo.com

One of the tourist destinations in North Sumatra is Lake Toba. Lake Toba is the largest caldera lake in the world formed from the eruption of Supervolcanic Mount Toba. Lake Toba has a length of 100 kilometers, 30 kilometers wide, and 505 meters deep (1,666 feet) [2]. One Tree Hill is a tourist attraction that has natural potential such as the stunning view of Lake Toba so that many tourists come to visit the region. In this area, there is no tourism area available which not only provides accommodation but also facilities that can satisfy tourists. Therefore to facilitate tourists, this design chose Resort Hotels as a project case with the name "One Tree Hill Hotel Resort."

## 2. Literature Review

### Comparative Study of Architecture that Has Similar Functions

Hotel Resort is a hotel built in tourist attractions. The purpose of this kind of hotel development is of course as an accommodation facility from a tourist activity [3]. Bali Music is located in Tabanan Regency, one of the most fertile and beautiful areas of Bali. Here, the landscape ranges from volcanic mountains and verdant rice terraces to beautiful black sand beaches overlooking the Indian Ocean (Table 1). Several concepts in this Bali Soori Resort Hotel, building orientation to the south to optimize the view of buildings, use cross-ventilation, have cultural facilities such as making wood carvings, farming, and painting (Figure 1) [4].

**Table 1.** Building Information

Aspect	Description
Architect	SCDA Architect
Location	Tabanan, Tabanan Sub-District, Tabanan Regency, Bali, Indonesia
Area of	22000 m <sup>2</sup>
Year of development	2010

(Source. <https://www.archdaily.com/797839/soori-bali-scda-architects>)



**Figure 1.** Soori Bali

(Source. <https://www.archdaily.com/797839/soori-bali-scda-architects>)

### Comparative Study of Architecture that Has Similar Themes

Respect To The Traditions is an architectural concept that looks at history as a storehouse of rich forms and high aesthetic value. Post-Modern Architecture appreciates historical memory. Post-Modern architecture claims the building is rooted in history or tends to look back on history [5]. Grand Mosque West Sumatra is the largest mosque in West Sumatra, which is located facing Khatib Sulaiman street, Nort Padang District, Padang City. This mosque was still in the construction stage since the laying of the first stone on December 21, 2017. The construction of this mosque consists of 3 floors (Table 2) [6].

**Table 2.** Building Information

<b>Aspect</b>	<b>Description</b>
Location	Padang City, Sumatera Barat, Indonesia
Leadership	West Sumatra Provincial Government
Architect	Rizal Muslimin
Capacity	5.000-6.000 People
Long	65 meter
Wide	65 meter
High	47 meter
Year of development	December 21, 2007

(Source. [https://id.wikipedia.org/wiki/Masjid\\_Raya\\_Sumatera\\_Barat](https://id.wikipedia.org/wiki/Masjid_Raya_Sumatera_Barat))

Some of the concepts in the Great Mosque of Padang, among others, the roof of the mosque tapping on the four sides hurts the water collected in the middle, the water is recycled into clean water for the needs of the mosque, The mosque building uses the roof of the space frame and results in a natural sound from a wide span The building is high enough to be used for air circulation, the shape of the mosque wall which has a triangular carving in which there are six angles had become a discussion of various circles, but actually has a philosophy that is three stoves Sajarangan, three rope sailing ( Ulama, Ninik Mamak, Cadiak Pandai ) who must hold fast to the pillars of faith as a binder of all elements in the midst of society, In the Great Mosque of Padang, also uses elements of Minangkabau Songket ornaments on the facade, The shape of the acute angle and represents the roof of the traditional house of Minangkabau: Rumah Gadang (Figure 2 ) [6].



**Figure 2.** Mosque Raya Padang  
(Source. [https://id.wikipedia.org/wiki/Masjid\\_Raya\\_Sumatera\\_Barat](https://id.wikipedia.org/wiki/Masjid_Raya_Sumatera_Barat))

### **3. Methodology**

The problem-solving methodology is obtained using identifying problems that exist in the design site to solve the problem or find the best solution for the design. Formulate the problems found in the design site and make the potential site for analysis to be made and potential design. To accommodate tourists and refine the culture of North Sumatra, data collection is the process of finding data relating to the design of both primary or secondary data. Primary data collection using literature study, general data collection by a comparative study.

### **4. Result and Discussion**

#### **The Concept of Building Mass**

The concept of the mass composition of the hotel uses the postmodern theme by modifying the form of the traditional house of Karo to respect the traditions regarding form and material and does not leave the traditional house element, the characteristic of this hotel using the traditional Karo roof. The composition of the masses is made to follow a design site that aims to get different views in each room. The hotel consists of 4 floors, Standard Room 1st Floor, 2nd Floor for Deluxe Room, 3rd Floor for Suite Room and Presidential Suite, 4th Floor for Café, and Roof Garden. This hotel is also equipped with access to buggy cars every floor to pick up visitors (Figure 3).

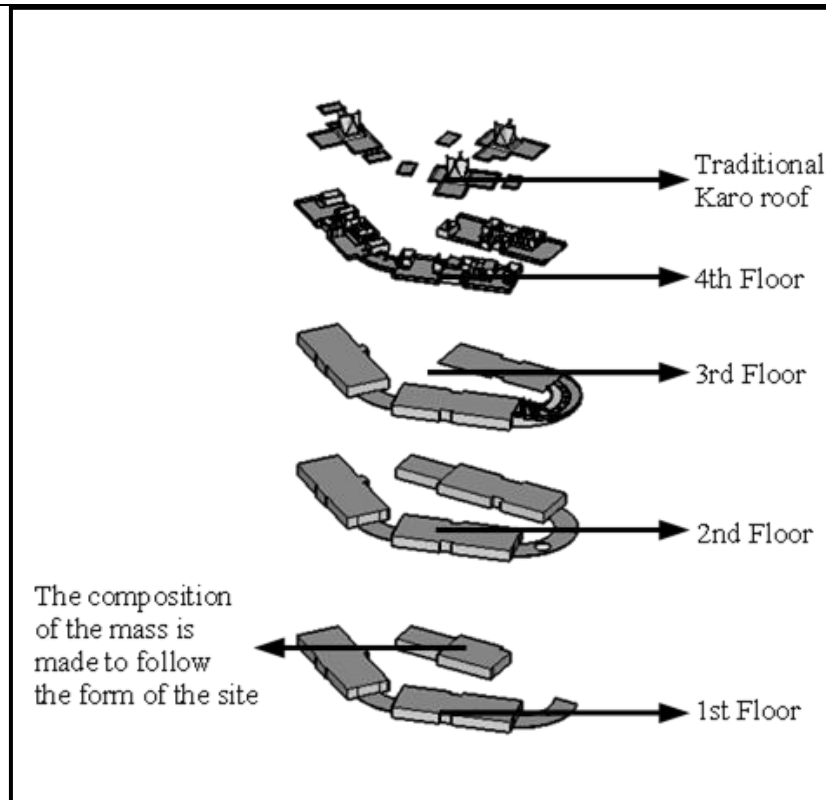

**Figure 3.** The Composition of the Hotel Mass

The concept of mass cottage composition consists of two floors, the first floor to stay and the second floor as a roof garden. There are eight cottages that vary according to the tribe in North Sumatra; Each cottage has a different roof and ornament (Figure 4).

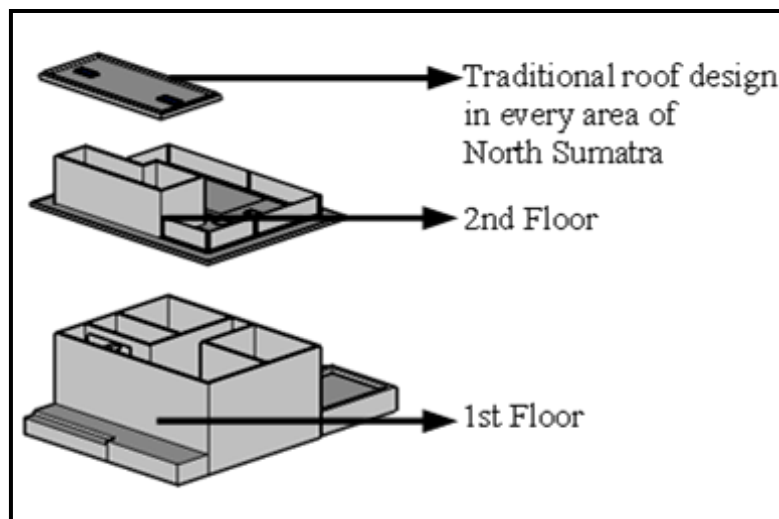
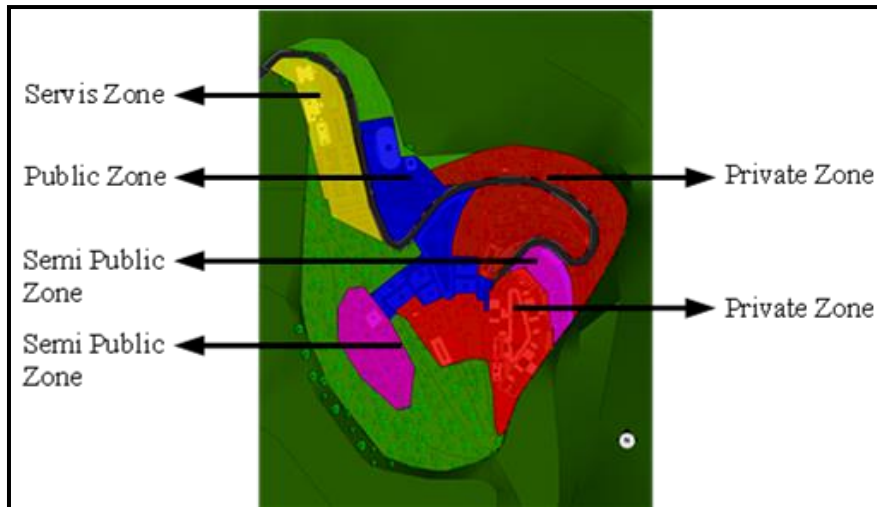

**Figure 4.** The Composition of the Cottage Mass

**Zoning Concept**

There are 3 zones in the design of this Resort Hotel. This zone is divided based on the activity system, the service zone is placed at the front in order to facilitate employee access and service vehicles, the public zone is placed in the middle as an activity information center, the private

zone is placed on the mountain to keep visitors comfortable, the semi-public zone is placed between public and private zones as a barrier between zones (Figure 5).



**Figure 5.** Zona Distribution

**Circulation Concept**

The concept of tourist circulation using a buggy car to seven locations that are desired by contacting the receptionist number or directly to the available buggy car park. Parking visitors are made at one point to maintain the privacy of tourists, and parking is also provided in front of the cottage for visitors who stay. Pedestrian circulation is also made along the pedestrian path; there is also a pedestrian route using escalators because it passes through a high contour to the hotel (Figure 6).

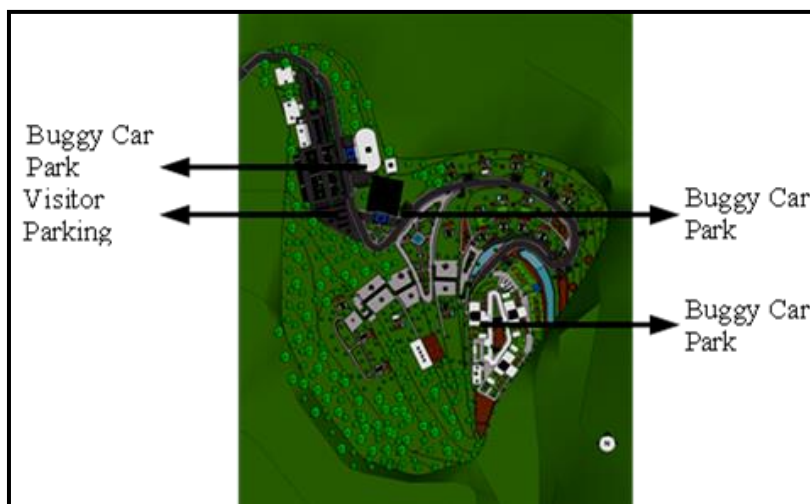

**Figure 6.** Buggy Car Parking Map

**Building Orientation Concept**

The orientation of this building facing southeast and facing east is a very nice view and gets the morning sun. The orientation of this building is also influenced by the view and contour of the site which makes all buildings not overlap with each other's view (Figure 7).

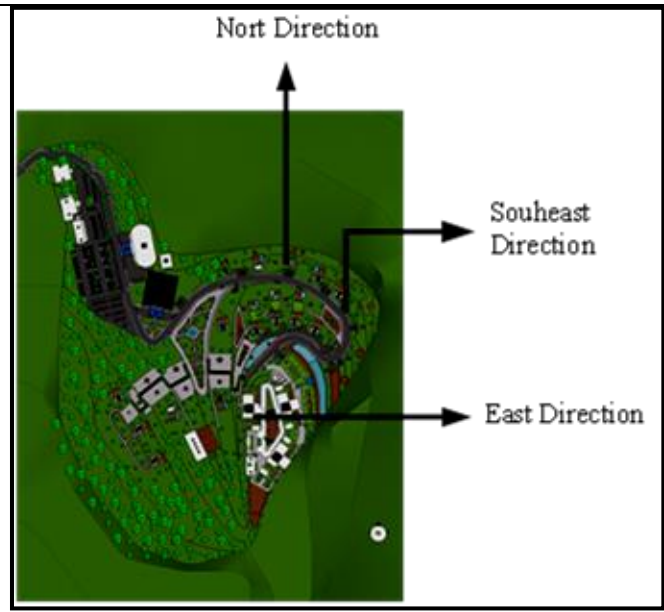

Figure 7. Building Orientation Concept

### Green Concept

The green spatial concept at this site uses plants that are beneficial for the environment such as, the Acacia Tree, to clean up pollution, Lavender to drain mosquitoes, Pandan Bali to make the air smell must be around (Figure 8).

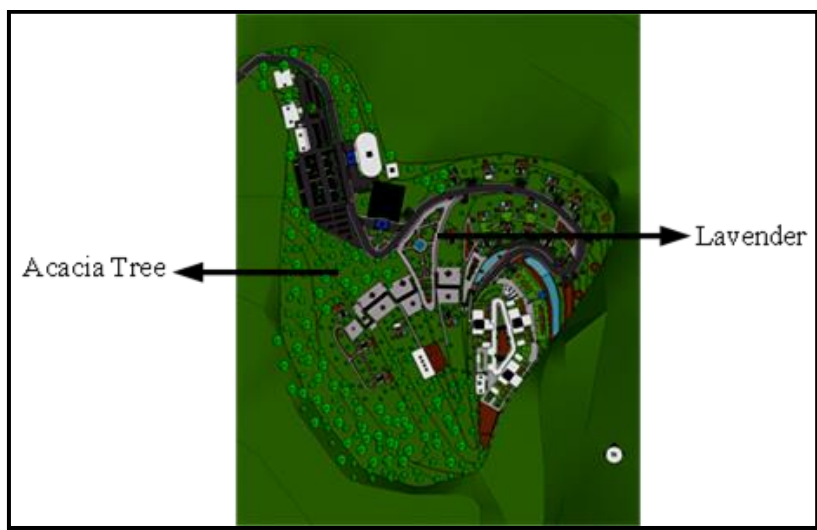
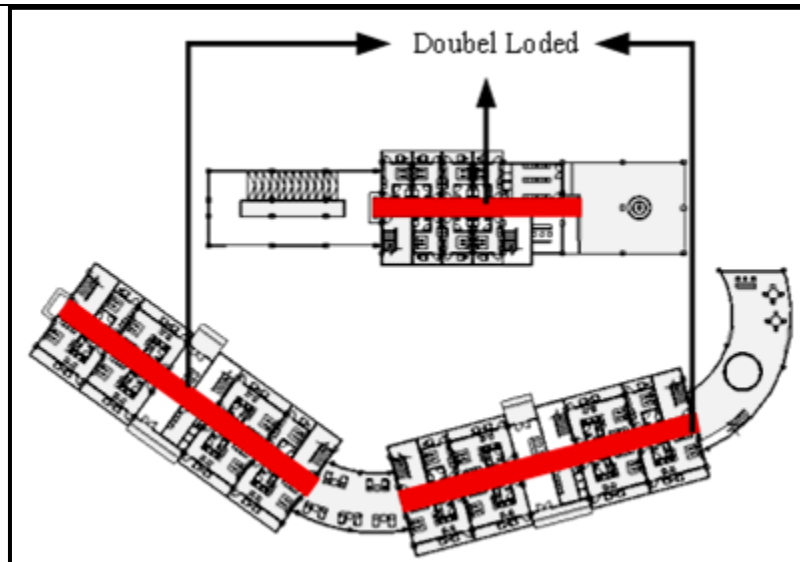

Figure 8. Vegetation Site Map

### Inner Spatial Concept

The concept of indoor space uses a double-loaded system, which is adapted from the existing house scheme Karo and applied to the hotel which aims to get a room that has a different atmosphere and view (Figure 9).



**Figure 9.** Karo Traditional House Circulation System and Hotels

## 5. Conclusion

From the need for reconciliation, tourism and the increasingly disappearing culture in North Sumatra in a building a resort hotel that functions to support tourists. Resort hotel buildings are built by applying the cultural themes in North Sumatra that function to preserve and restore the culture of North Sumatra.

## Acknowledgment

The Journal Post Modern Architecture Application on One Tree Hill Hotel Resort was created to provide solutions, concepts, and responses to the location of One Tree Hill. One Tree Hill is planned to be built by Resort Hotel by the organizer of Taman Simalem Resort, Karo District, North Sumatra.

## REFERENCE

- [1] B. Julaihi Wahid, *Arsitektur Dan Budaya Sumatera Utara*, Yogyakarta: Graha Ilmu, 2013.
- [2] [Online]. Available: [https://id.wikipedia.org/wiki/Danau\\_Toba](https://id.wikipedia.org/wiki/Danau_Toba).
- [3] E. Marlina, *Panduan Perancangan Bangunan Komersial*, Yogyakarta: andi, 2008.
- [4] [Online]. Available: <https://www.archdaily.com/797839/soori-bali-scda-architects>.
- [5] Ikhwanuddin, *Menggali Pemikiran Posmodrenisme*, Yogyakarta: Gadjaja Mada University Press, 2005.
- [6] [Online]. Available: [https://id.wikipedia.org/wiki/Masjid\\_Raya\\_Sumatera\\_Barat](https://id.wikipedia.org/wiki/Masjid_Raya_Sumatera_Barat).